



CHATTERTON | REES



Fordham Court 9-13 De Vere Gardens, London, W8 5AP

£1,750,000





Fordham Court 9-13 De Vere Gardens

London, W8 5AP

- 2 Bedrooms
- Newly Refurbished
- Opposite Hyde Park
- 2 Bathrooms
- Lift
- Period Building

An exceptional two-bedroom, two-bathroom apartment situated within an elegant period conversion on one of Kensington's most prestigious addresses, directly opposite Hyde Park.

The property has been meticulously refurbished to an outstanding standard, combining timeless architectural features with contemporary design. The interiors showcase bespoke joinery throughout, complemented by carefully selected marble finishes, creating a refined and luxurious living environment.

The accommodation comprises a beautifully appointed open-plan reception and kitchen, thoughtfully designed for both entertaining and everyday living, alongside two well-proportioned double bedrooms and two stylish bathrooms. Every detail has been considered to maximise space, light and functionality.

Further benefits include lift access within the building, enhancing convenience and accessibility.

De Vere Gardens is ideally positioned moments from the open green spaces of Hyde Park, while the extensive amenities of Kensington High Street are within easy reach. Residents benefit from a superb selection of restaurants, boutiques and transport links, making this an exceptional central London address.

£1,750,000







Floor Plans

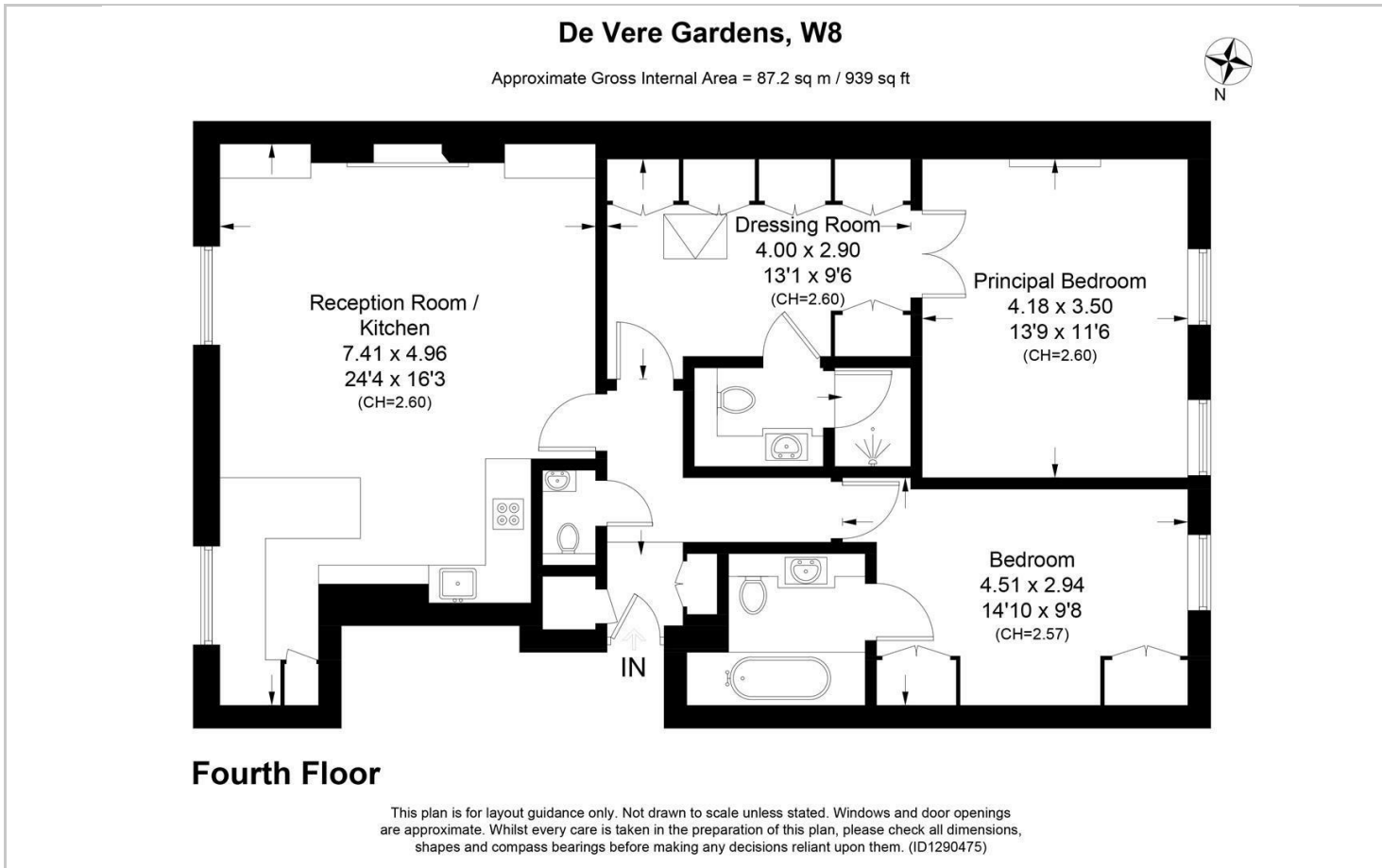

Viewing

Please contact our Chatterton Rees Office on 020 3780 0580 if you wish to arrange a viewing appointment for this property or require further information.

The particulars are set out as a general outline only for the guidance of intended purchasers or lessees, and do not constitute, any part of a contract. Nothing in these particulars shall be deemed to be a statement that the property is in good structural condition or otherwise nor that any of the services, appliances, equipment or facilities are in good working order. Purchasers should satisfy themselves of this prior to purchasing.

Location Map

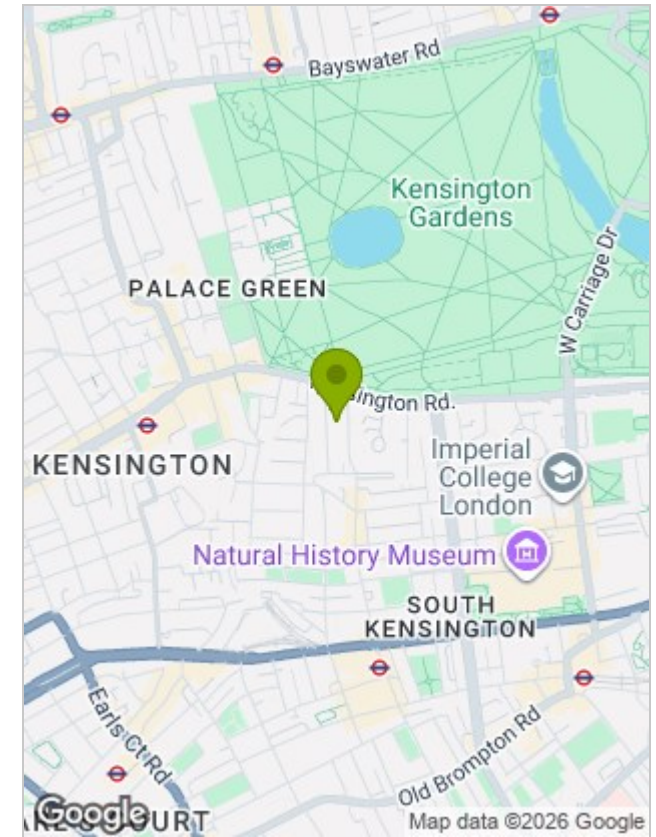

Energy Performance Graph

